

HEAD TUBE(頭管)

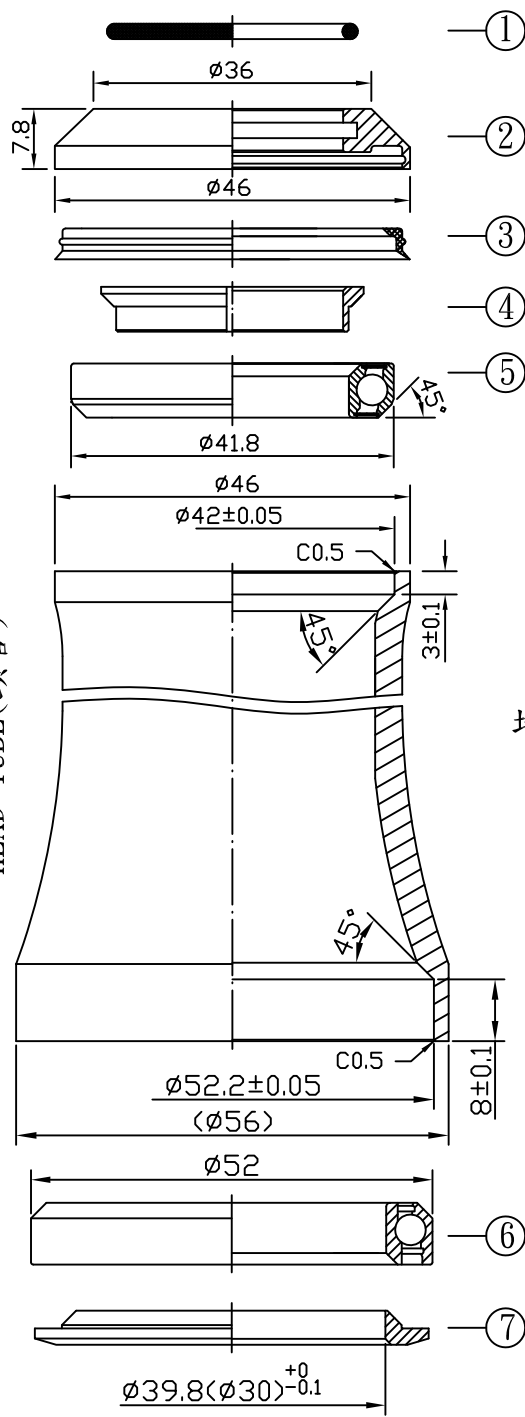

堆積高度(STACK HEIGHT)=10.1±1mm

可選配之上塞高度  
(TOP COVER IS OPTIONAL)

型號(MODEL NO.): H373

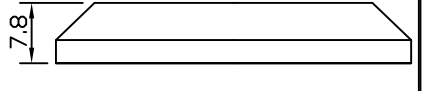

型號(MODEL NO.): H373M

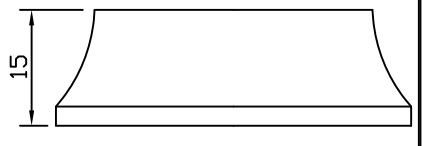

型號(MODEL NO.): H373H

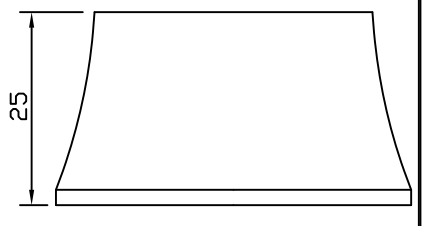

NO.	零件名稱 PART NAME	材質 MATERIAL	圖號 DRAWING NO.	台量 Q'TY	尺寸 DIM. DESCRIPTION
1	O形圈 O-RING	橡膠 NBR	120-8	1	ID28.5xø2
2	上塞 TOP COVER	鋁合金 6061/T6	51-3	1	1-1/8"
3	防塵蓋 UPPER WATER SEAL	橡膠 NBR	273-0	1	
4	鋁斜管 COMPRESSION RING	鋁合金 6061/T6	51-2	1	1-1/8"
5	密封式軸承 AC SEALED BEARING	軸承鋼 SUJ2	NHB-6B	1	OD41.8x45°x45°
6	特大密封式軸承 SUPER OVERSIZE AC SEALED BEARING	軸承鋼 SUJ2	NHB-15	1	OD52x45°x45°
7	鋁下塞 CROWN RACE	鋁合金 7075/T6	151-6 (153-6)	1	ø39.8(ø30) <sup>+0</sup> <sub>-0.1</sub>

- 全隱藏式車頭碗組
- 1.5" 轉1-1/8" 前叉立管
- 車頭管外徑上小下大  
(建議車頭管外徑上半部46mm, 下半部56mm)
- 鋁合金(6061)上塞
- 鋁合金(7075)下塞(內徑39.8mm或30mm)
- 斜接觸角度密封軸承(下半部軸承加大)

- Full-integrated headset
- For 1-1/8" upper, 1.5" bottom steerer
- For different outerdiameter head tube
- 6061/T6 cnc machined top cover with seals
- 7075/T6 cnc machined crown race  
(inner diameter 39.8mm or 30mm)
- Upper: angular contact sealed bearing  
Lower: super oversize angular contact sealed bearing

單位 UNIT	mm	比例 SCALE	1:1	日期 DRAWING DATE	2001.03.09	角法 VIEW	
型號 ITEM NO.	NECO 373/373M/373H						版次(REV):A
品名 PART NAME	H373/H373M/H373H 組立圖(Assembly Drawing)						
規格 DIMENSION	1-1/8" x42x52.2x39.8(1-1/8" x42x52.2x30)						
圖號 PART NO.	H373(H373M/H373H)-組立圖-A						